

MMT INTERACTIVE VIDEO WALLS





4x2 55" (landscape) Touch Wall
Free standing

Bottom View 1:20



Isometric View 1:50

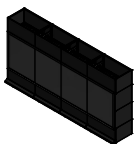

Top View 1:20



Isometric View 1:50
(Back View Without Cover)

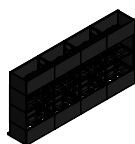

Righthand View 1:20



Front View 1:20

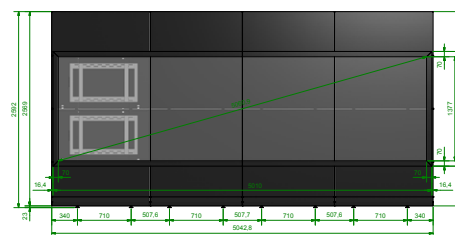

Lefthand View 1:20

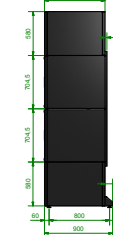

Back View 1:20

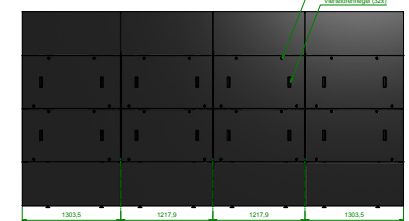



Bottom View 1:20



2x2 55" (portrait) Touch Wall
Wall mounted



Righthand View 1:20

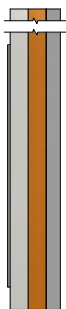

Front View 1:20

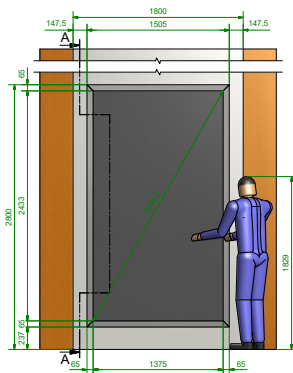

A-A 1:20



B-B 1:20

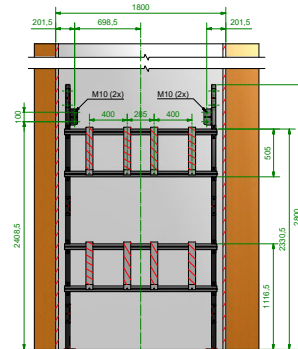

Isometric View 1:50

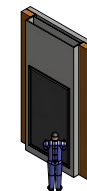

Top View 1:20

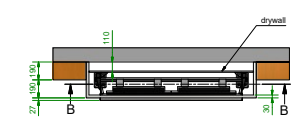



4x3 (landscape) Touch Wall
Freestanding



Righthand View 1:20



Front View 1:20

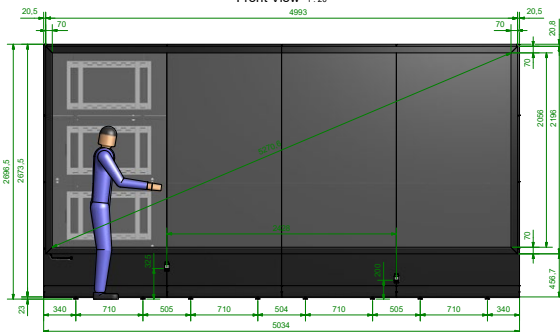

Lefthand View 1:20

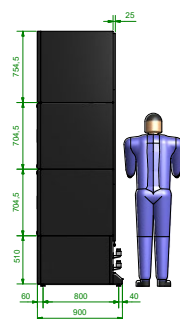

Back View 1:20

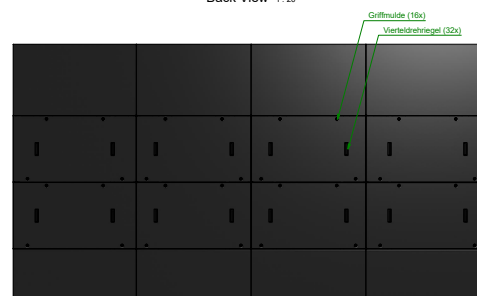

Top View 1:20



Isometric View 1:50
(Back View Without Cover)

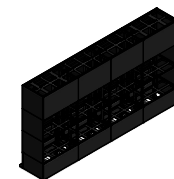



2x2 55" (landscape) Touch Wall
Wall mounted
with frontservice system



Isometric View 1:20

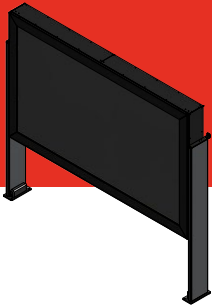

Front View 1:20



Lefthand View 1:20



Isometric View 1:20



Front View 1:20



Lefthand View 1:20

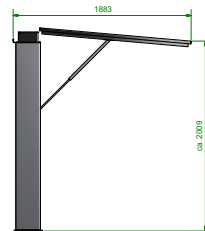

Isometric View 1:20

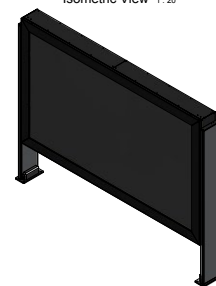

Front View 1:20

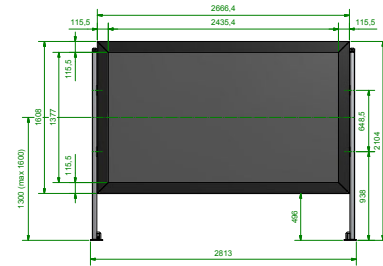

Lefthand View 1:20



Top View 1:20



2x2 55" (landscape) Touch Wall
Wall mounted

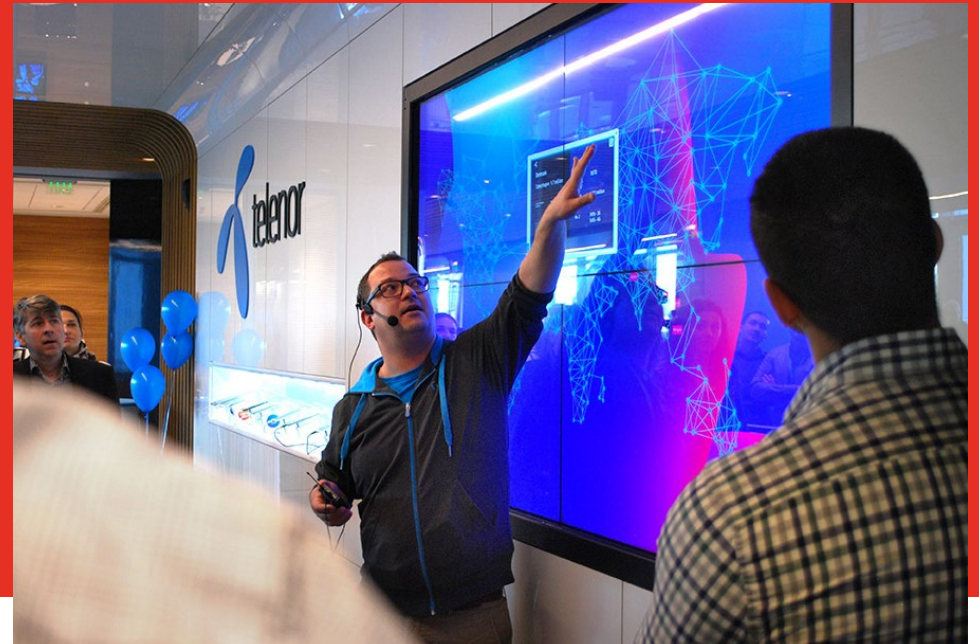

Video Wall



Video Wall Configuration 5x2



Video Wall Configuration 5x3 (46 inch screens)



Video Wall Configuration 2x2 Portrait



Video Wall Configuration 5x3





The **MMT TouchWall** is an interactive, modular videowall solution based on state-of-the-art technologies. Thanks to the **large active area**, multiple users can access the interactive media contents **simultaneously**. There are no limitations - any company, product or service can be advertised and presented using the MMT TouchWall.

Designed and built after years of testing, constant improvements and experience on the field, the advanced MMT modular system is easy to transport and assemble. The **light-weight construction** is fully made from aluminum and can be powder-coated in any RAL color. It's available as **free-standing solution or mounted to a back wall**.

With a diagonal size of **up to 500"**, it's the ideal device for amazing presentation for any type of use in stores, exhibitions, events or in museums.

The **advanced MultiTouch sensor** is able to recognize **up to 40 touch points simultaneously**, with an incredible accuracy

of 2.7mm. It also comes with an additional protection against light interferences (upon request). The toughened, **ultra-clear safety glass** features an anti-glare treatment on both sides in order to avoid any reduction in the image quality and brightness.

MMT INTERACTIVE VIDEO WALL

CONSTRUCTION	Ruggedized metal construction (light-weight aluminium) Modular & durable Available in any RAL Color
SCREEN MODULES	46" or 55" Direct-LED backlight 700 cd/m2 with optimized power consumption Full-HD Resolution with 4K Loop-Through Ultra Narrow Bezel - 3.5mm distance from image to image (55" only)
ORIENTATION	Landscape & Portrait Mode
TOUCH SENSOR	MultiTouch with up 40 touch points Anti-Sunlight Feature upon request
SAFETY GLASS	5mm tempered safety glass Double-sided anti-glare treatment Ultra clear appearance
OPERATION	24/7 certified
SERVICE	Service doors for access to monitors & hidden PC electronics



Contact us

DEKOM AG

Kellerbleek 3
22529 Hamburg
Germany

Germany: 0800 80 81 81 1
International: +49 40 80 81 81 - 188

