

logitech®

zoom



DATA SHEET

LOGITECH TAP IP

Start your Zoom meetings with just one touch with Logitech Tap IP, a network-connected touch controller for Zoom Rooms. With clean and secure cable management and a range of mounting options, Tap IP brings ease and convenience to your Zoom Rooms meetings.

ZOOM ROOMS TOUCH CONTROLLER WITH POE CONNECTIVITY

More than a meeting room controller, Logitech Tap IP helps you achieve a consistent and seamless user experience for all your Zoom Rooms. This purpose-built touch controller has just the right presence with a spacious 10.1" display and sleek, low profile. With a single Power over Ethernet (PoE) connection and a variety of mounting options, Tap IP is designed for scalability, allowing deployment into any meeting space. Prevent accidental disconnections, thanks to built-in cable retention and strain relief, and be confident that your Zoom Rooms stay ready for the next meeting.

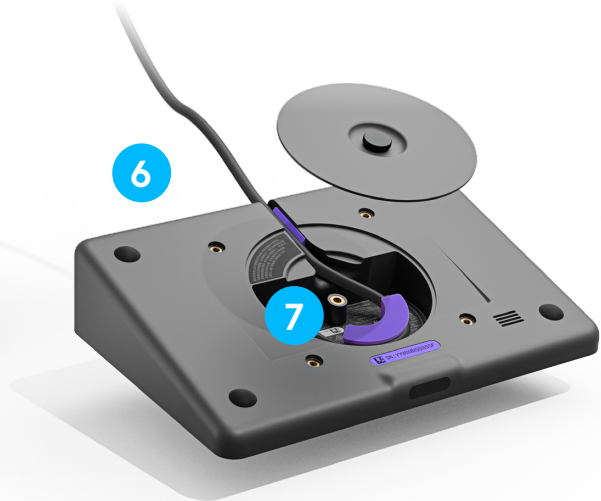

EASY TO USE AND SIMPLE TO SET UP

- 1 **One-touch join:** Easily start and join meetings with just a tap.
- 2 **10.1" touch display:** A spacious, responsive touch screen resists fingerprints for high legibility — and it's sealed to protect components, too.
- 3 **Motion sensor:** Built-in motion sensor allows for always-on readiness when a user approaches, and saves power when idle.
- 4 **Sleek, low profile:** Comfortable 14° angle allows for easy viewing, while being unobtrusive in your meeting space.
- 5 **Ultrasonic pairing:** Share content and pair your mobile or laptop devices wirelessly and effortlessly with Zoom Rooms.
- 6 **Single PoE connection:** A single cable for both power and data means flexible placement almost anywhere, untethered to the room system, reducing the need for additional cable runs.
- 7 **Clean and secure cable management:** An integrated strain relief and cable management system hides and secures the network cable within the enclosure to prevent unwanted disconnections.
- 8 **Multiple mounting options:** Secure Tap IP almost anywhere with the available Table, Riser and Wall mounts for convenient placement near in-room participants.

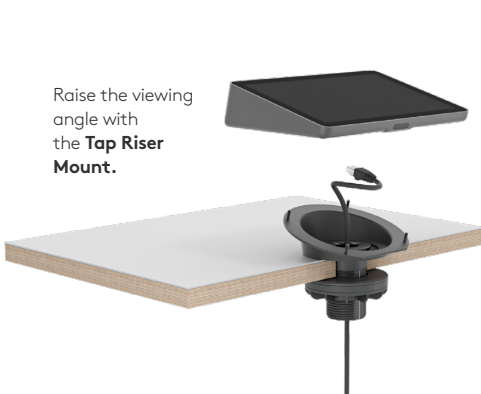

Raise the viewing angle with the **Tap Riser Mount**.

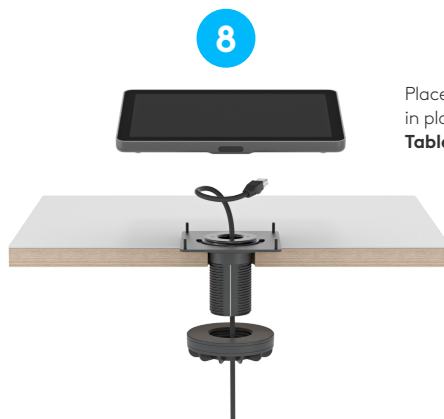

Place flat and secure in place with the **Tap Table Mount**.



Save space at the table with the **Tap Wall Mount**.

BUILT FOR ZOOM ROOMS

Logitech and Zoom have partnered together to provide easy to use and manage video experiences. With Tap IP it's easy to start and control your Zoom meetings with a tap of a button.

Easily transform any meeting space into a video enabled Zoom Rooms experience with Tap IP and Logitech room solutions. Start with pre-configured solutions that include all-in-one video bars, and conference cameras with a compute of your choice. Elevate your meeting spaces and office with additional devices like scheduling panels, whiteboard cameras, and digital signage to empower the modern workspace for hybrid teams. To learn more, visit logitech.com/Zoom.

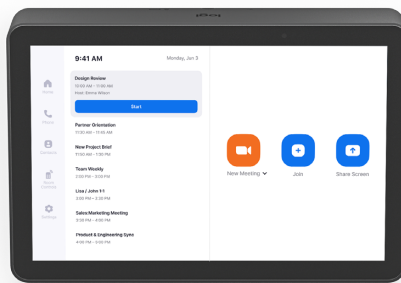

Fits rooms of virtually any shape or size

Logitech Solutions for Zoom Rooms empowers the modern workspace for hybrid work. Whether it's creating a more equitable meeting experience, or helping people find a meeting space, Logitech has solutions that help people get the most out of their meetings. With a variety of deployment options, Logitech Solutions for Zoom Rooms ensures that you get a consistent experience in any meeting space.

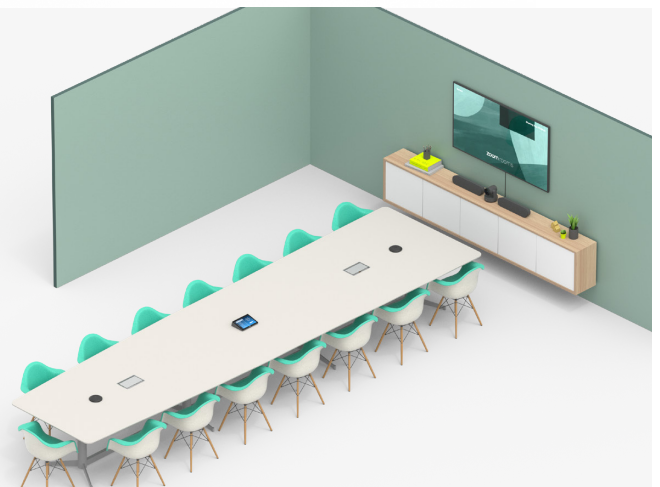

Equip your meeting space

Logitech room solutions include everything you need to build and customize your Zoom Rooms experience.

Featuring Tap Scheduler, Tap IP, RoomMate, Scribe, and our Rally video bars and conference cams.





PRODUCT SPECS		
Device: Total Height x Width x Depth 2.21 x 9.69 x 6.74 in 56.1 x 246.2 x 171.3 mm 1.0 kg (2.2 lbs)	Touchscreen 10.1" diagonal screen Display Angle: 14° Viewing Angle: 85° (up/down/left/right) Resolution: 1280 x 800 Display Type: IPS (In-Plane Switching)	LCD Panel with LED Backlighting Capacitive, 10 points multi-touch Brightness: 400 nits Contrast: 1000:1 Anti Fingerprint: Oleophobic coating
POWER & PORTS	INTERFACES	PACKAGE CONTENTS
Power over Ethernet (PoE), IEEE 802.3af Type 1, Class 3 device Ethernet: 10/100mbps WiFi: 802.11a/b/g/n/ac Bluetooth 5.0	Internal cable retention and strain relief system Integrated ultrasonic speaker Integrated PIR Motion Sensor Integrated accelerometer Integrated ambient light sensor 100mm x 100mm VESA FDMI	Tap IP Touch Controller VESA Mounting Screws (4) Microfiber Cloth Documentation
COMPATIBILITY & CERTIFICATIONS	ENVIRONMENTAL	OPTIONAL ACCESSORIES
Integrates with Zoom Rooms as a Zoom Rooms Controller. See www.logitech.com/support/tap-compatibility for pending and granted certifications and compatibility information.	Operating Temperature: 0 to 40°C Storage Temperature: -40 to 70°C Humidity: 10 to 95%	Table Mount Riser Mount Wall Mount
	SECURITY	DEVICE MANAGEMENT
	Full Disk Encryption: AES-128 Data Encryption: Symmetric Keys, PKI Device Identity: Protected by device attestation Key Protection: Arm TrustZone, RPMP Device Security: Kensington Lock	Monitor and manage with Logitech Sync remote management and Zoom Device Management platforms.
WARRANTY		PART NUMBERS
	Ensure peace of mind for the typical depreciation and replacement cycle of most conference room equipment through the purchase of an extended warranty, which adds one additional year to the original Logitech manufacturer's two-year warranty. Contact your reseller for availability. Standard 2-year limited hardware warranty included	Logitech Tap IP in Graphite 952-000085 Logitech Tap IP in White 952-000088